



Pressurized UF Specification

Aftermarket Solutions - 9" Series

Memstar's *Aftermarket Solutions Series* pressurized ultrafiltration (UF) hollow fiber modules are engineered drop-in replacement products that provide owners of existing UF installations with a higher quality alternative to replace the originally installed products. Products utilizing Memstar's NIPS fiber technology are cost-effective, high-performing, and reliable.

Key Features and Benefits

- Engineered drop-in replacement modules = Simple, low effort, plug and play solution
- Optimized internal design = Reduced fouling by solids accumulation
- Outside to in filtration = Wider operating window allowing for higher turbidity feeds

Module Specifications

	UF-0915E	UF-0920E
Membrane Material	PVDF (NIPS)	
Nominal Pore Size (µm)	0.04	
Filtration Mode	Outside-In	
Housing Material	uPVC/ABS	
Potting Material	Epoxy/PU	
Filtration Surface Area (m ²) [ft ²]	51 [549]	77 [829]
Typical Filtrate Flowrate (m ³ /hr) [gpm]	2.0 - 6.1 [8.9 – 26.9]	3.0 - 9.2 [13.2 – 40.5]
Column volume (L) [gal]	35 [9.2]	39 [10.3]
Empty Weight (kg) [lbs]	48 [106]	61 [135]
L1 (mm) [inches]*	1,500 [59.1]	2,000 [78.7]
L2 (mm) [inches]*	1,630 [64.2]	2,130 [83.9]
L3 (mm) [inches]*	1,820 [71.7]	2,320 [91.3]
L4 (mm) [inches]*	1,860 [73.2]	2,360 [92.9]
L5 (mm) [inches]*	180 [7.1]	
R (mm) [inches]*	225 [8.9]	
A	Influent/Discharge Port DN50	
B	Filtrate Port DN50	
C	Concentrate Port DN50	
D	Air Inlet Port ID Φ10	

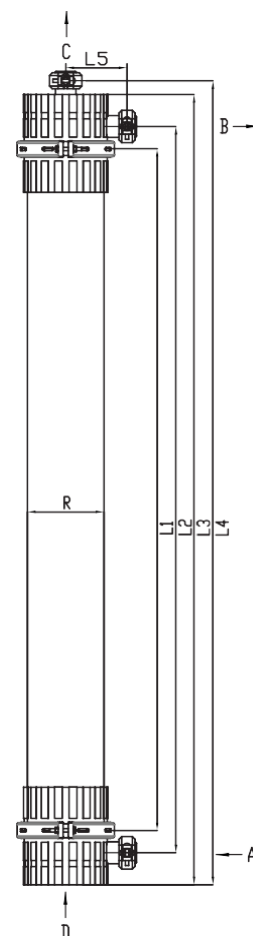

*Approximate dimensions. Check with Memstar for the most up-to-date values and applicable drawings.

MODULE OPERATING PARAMETERS	ALLOWABLE RANGE
Operating temperature (°C) [°F]	5 – 45 [41 - 113]
Typical flux (LMH) [gfd] ¹	40 – 120 [25 - 70]
Air Scour Flowrate (m³/hr/module) [cfm]	5 - 12 [2.9 - 7.1]
Instantaneous chlorine tolerance (ppm)	5,000
Maximum lifetime chlorine tolerance (ppm-hrs)	2,000,000
Maximum feed turbidity (NTU) ²	300
Maximum transmembrane pressure (bar) [psi]	2.1 [30]
Maximum feed pressure (bar) [psi] ³	6.25 [90]
Oil content in feed water (ppm)	< 0.5
pH range	Operating: 2 – 11; Cleaning: 1 – 12
Allowed particle size in feed water (mm) ²	≤ 0.3 ≤ 0.12 for seawater feeds

1. Flux selection depends on feed type and water quality. Please consult Memstar for flux selection.

2. Please consult Memstar for higher values.

3. At maximum temperature of 20°C.

Product Numbering Guide

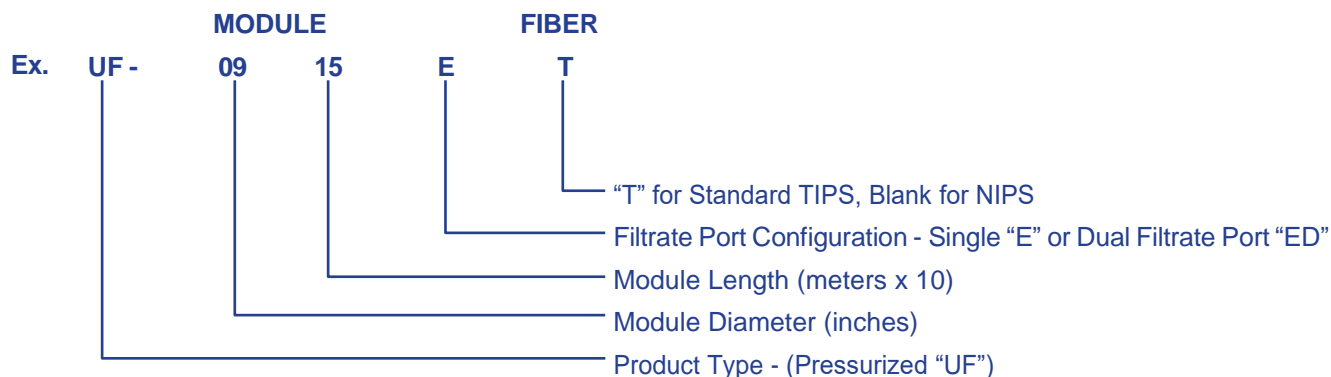

USA

Memstar USA

3655 Pollok Drive
Conroe, Texas 77303

TEL: +1 855-MEMSTAR
Sales@MemstarUSA.com

Singapore

Memstar Pte. Ltd.

11 Kian Teck Drive
Singapore 628828

TEL: +65 67752512
Singapore@Memstar.com.sg

MemstarUSA.com